

**Family Surgical Lounge  
Hartford Hospital  
Hartford, Connecticut**



**Hallway Y shape divider visitor seating**

Hartford Hospital is the region's leading medical center, recognized for services from specialized physician's care to their Level 1 Trauma Center.

Central to the medical campus are the surgical facilities, with in-patient buildings on each side.

Serving all departments and emergency surgery is the newly renovated **Family Surgical Lounge.**



Taking advantage of the extensive sizes available in the **Laurel Series**, the architect has been able to provide seating for 48 people within limited space. Chair segments with true radius curved seat fronts and chair backs soften the environment, while providing many individual areas for people to wait.



**TV corner visitor seating areas**

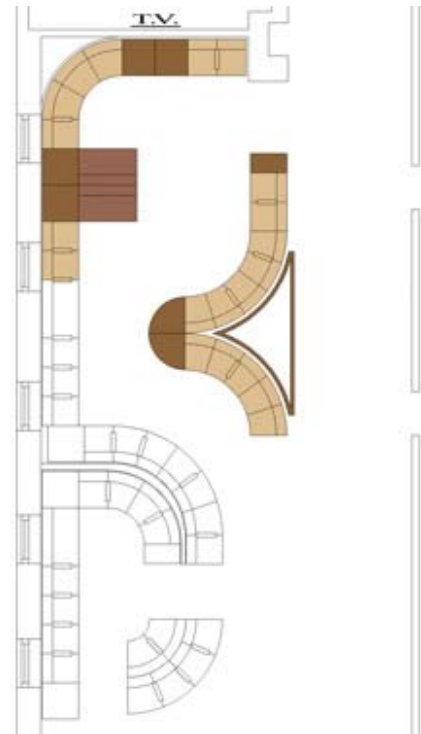

**Lounge: 48 feet long by 17 feet wide  
Highlighted on floor plan above:  
TV corner visitor seating areas  
Hallway Y shape divider seating**

**Hartford Hospital**  
**Family Surgical Lounge Page 2**



Curved back to back chair segments create sculptural seating areas that fit well and yield maximum seating in limited spaces. Individuals or family members can relax near refreshments, read, watch TV, or confer with doctors in the seating areas formed by the plan.

Full size templates of all the chair and table segments were provided to guide building out curved walls and flooring patterns, taking the risk out of custom floor plan finishes.

**Back to back seating for eleven visitors**

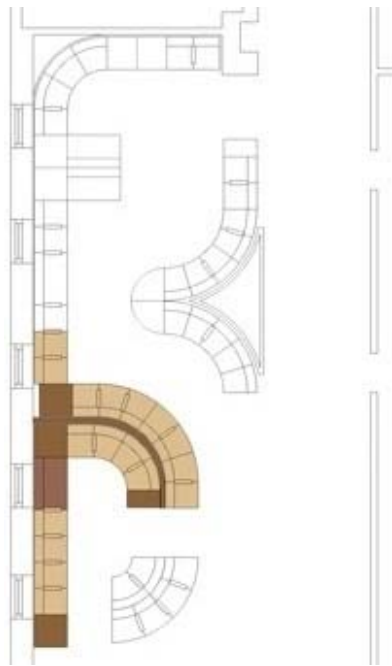

Individual seating spaces are divided by mid-arms; double width units accommodate families or longer term waiting / resting.

Vinyl chair covers wipe off for daily cleaning, new covers may be replaced on site for damaged covers or for future change to new décor.