

Avoyelles Hospital

Marksville, Louisiana



Avoyelles Hospital has been committed to providing quality healthcare to the community from its founding in 1938 to the addition of the new Emergency department in 2002. While patients are received and treated in the modern emergency facilities, their families are welcomed in the cheerful sunny waiting area.



Laurel Series standard model sizes fit the floor plan with maximum seating, softening the room with comfortable individual seating spaces.

Practical as it is beautiful, cherry grain laminate arm, table tops and nylon matrix material chair seats wipe clean for easy maintenance.

Replaceable upholstery covers allow quick repairs or future renewal to keep high use areas looking good.



Combining state of art medical facilities with finely detailed interior finishes reflects the collaboration of architect Wayne Lawrence Coco A.I.A. with interior design by Petra Coco and Sherri Slone, of Coco & Company.

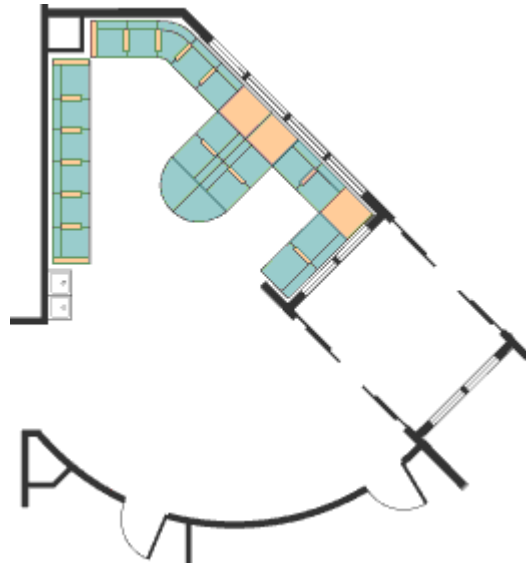

Avoyelles Hospital



Front lobby, original building



Above: New ER area

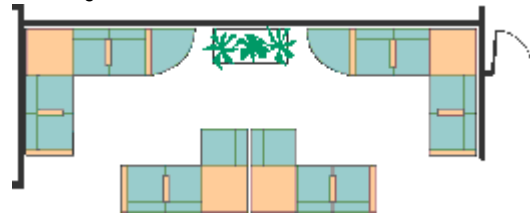

Laurel Series chairs and tables in matching fabric and finishes carry the friendly new look of the ER area to the original lobby at the front entrance of the hospital building.

Individual seating for fourteen is arranged into smaller waiting areas for visitors, converting a long narrow space into a quiet retreat looking out onto the entry gardens.

The Laurel Series seating will grow with the hospital, rearranging into new areas, changing into new covers and combining with additional units to serve new needs.