

Sports Center at the Palladium New York University



Under the new multi-story Palladium Residence Hall is a complete sports center with a pool, basketball court, cardio fitness program and weight training.

LS Series seating defines the Sports Lounge central social area. Inward and outward chair segments repeat the architectural lines of the walls and floor.



Plan: Fit of special size chair segments to the curvature of the flooring was confirmed on AutoCAD and full size site templates before production.

Above: LS Series sofas create smaller social areas to watch events on TV or on the basketball court below. Practical as well as comfortable, solid cherry arm caps repeat the lounges wood finishes; crypton finished fabric resists spills from refreshments.

Sports Center at the Palladium New York University



Team Room

LS Series chairs maximize comfortable seating, turning a small room into a sleek meeting space. An exact fit was achieved by using standard chairs in 28" and 30" widths with end arms to form sofas. Matching tables fill the corners.

Black Tuffalo upholstery wipes clean easily. Solid cherry arm caps and table tops add a warm wood finish.



Above: An extra room now serves as a comfortable lounge where coaches can meet with their teams and Sports Center staff can plan activities.

Focus on the front whiteboard or TV/video screen is further improved by carpeted platforms which raise the side and back chairs.

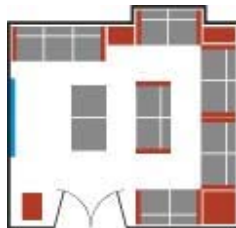

Team sports include basketball, volleyball, racquetball, swimming and water polo. Students can choose among weight training, a climbing wall and cardio and aerobic areas for individual fitness.